

# 9" CLAY PIPE CATCH BASIN STAND PIPE FOR EROSION CONTROL

MINIMUM STAND PIPE HEIGHT LEVEL TO THE TOP OF THE CONCRETE STRUCTURE,  
 MAXIMUM HEIGHT OF STAND PIPE IS 2" BELOW BOTTOM OF CB GRATE

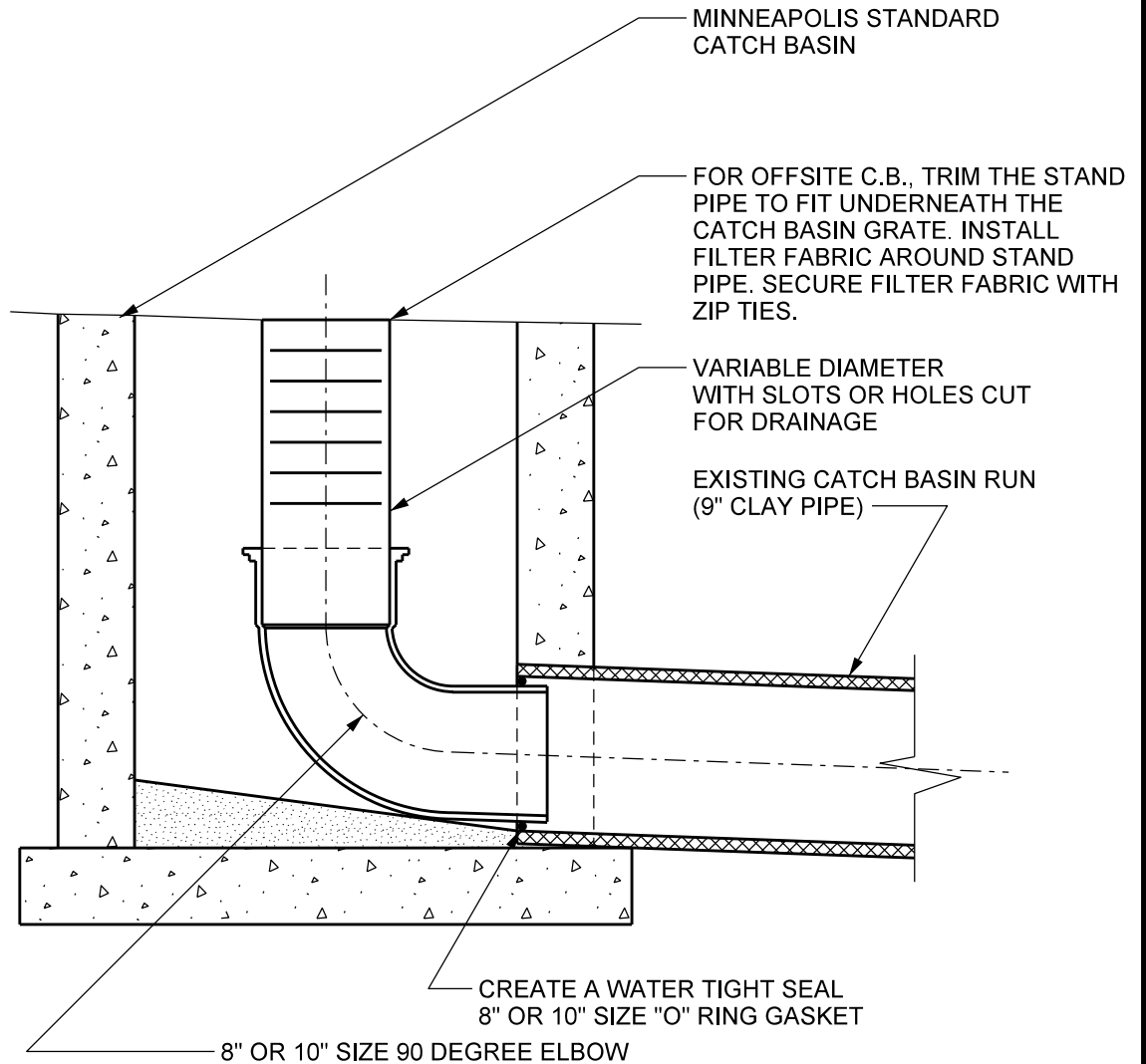

EMERGENCY MOBILIZATION MAY BE REQUIRED TO PREVENT LOCALIZED FLOODING DURING RAIN EVENTS TO IMPROVE FLOW RATE INSTALL A WRAP OF CHICKEN WIRE BETWEEN STAND PIPE AND GEOTEXTILE FABRIC DO NOT COVER TOP OF STAND PIPE WITH GEOTEXTILE FABRIC, THIS IS THE EMERGENCY OVERFLOW

NOTES:  
 WHERE C.B.'S ARE PAIRED, INSTALL EROSION CONTROL STAND PIPES ON DOWNSTREAM C.B., COVER UPSTREAM C.B.  
 INSPECT WEEKLY AND/OR AFTER EACH 1/2" RAINFALL,  
 CLEAN WHEN 1/3 FULL OR AS NECESSARY

USE HI-FLOW FILTER FABRIC, 200 GAL. PER MINUTE / SQ. FT.

MINNEAPOLIS CUSTOM  
 MNDOT SPEC. REF. 3891  
 NOT TO SCALE



DRW: DCD

DATE: 3/07

APP: HRS

DATE: 3/07

SEDIMENT CONTROL  
 CATCH BASIN STAND PIPE

STANDARD  
 PLATE  
 NO.  
 SEWR-8000