

NOTES:

EXTRA BOTTOM BARS PLACED ADJACENT TO ACCESS HOLE.

MINIMUM 1 1/2" COVER ON STEEL BARS.

THREE LIFTING CABLES PLACED AT 120° USED ON COVERS SMALLER THAN 60" UNLESS SPECIFIED.

TYPE II COVERS CAPABLE OF CARRYING A 9000 LB. WHEEL LOAD.

PROVIDE FULL MORTAR BED.

ALL REBARS ARE IN ENGLISH DESIGNATIONS.

MINNEAPOLIS STANDARD MH ALTERNATE IS A 27" CENTER HOLE MANHOLE TOP SLAB.

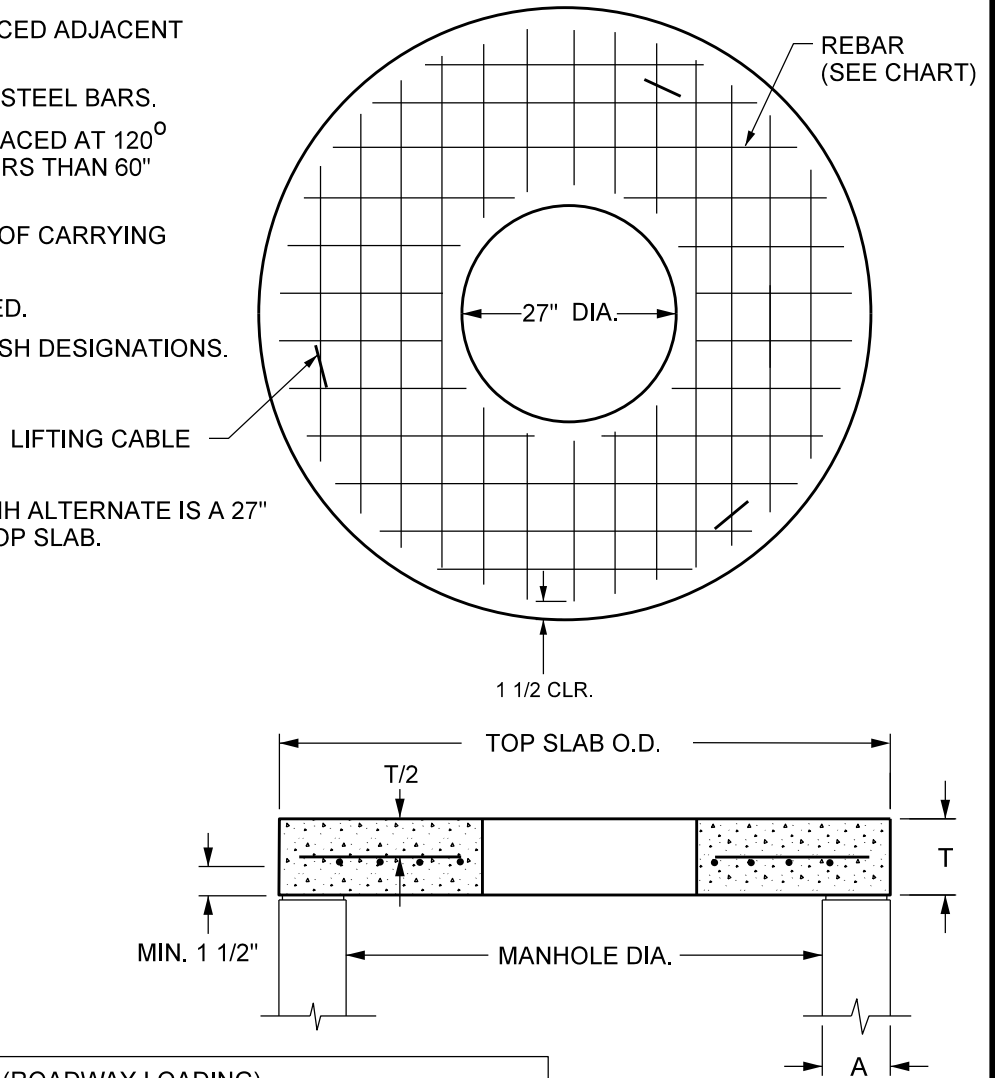

TYPE II (ROADWAY LOADING)						
MH DIA. (in.)	TOP SLAB O.D. (in.)	WEIGHT OF SLAB (lbs.)	"T" (in.)	"A" (in.)	BOTTOM BARS (in.)	TOP BARS (in.)
48	58	1140	6	6	#5 AT 6	
54	65	2000	8	6	#5 AT 6	
60	72	2525	8	7	#5 AT 4	#3 AT 6
66	79	3105	8	7	#5 AT 4	#3 AT 6
72	86	3740	8	8	#5 AT 4	#3 AT 6
78	93	4403	8	8	#5 AT 4	#3 AT 4
84	100	5140	8	9	#5 AT 4	#3 AT 4
90	106	5840	8	9	#5 AT 4	#3 AT 4
96	113	6680	8	9	#5 AT 4	#3 AT 4
102	119	7450	8	9	#5 AT 4	#3 AT 4

MPLS. STD. MH ALTERNATE

**REFERENCE
PLATE ONLY**

MINNEAPOLIS CUSTOM
MNDOT SPEC. REF. 2506
MODIFIED MNDOT 4020I
NOT TO SCALE

	DRW: MJS	DATE: 3/24	27" CENTER HOLE MANHOLE TOP SLAB	STANDARD PLATE NO. SEWR-5025
	APP: HRS	DATE: 12/06		