

TYPICAL CATCH BASIN CONSTRUCTION, MINNEAPOLIS STANDARD

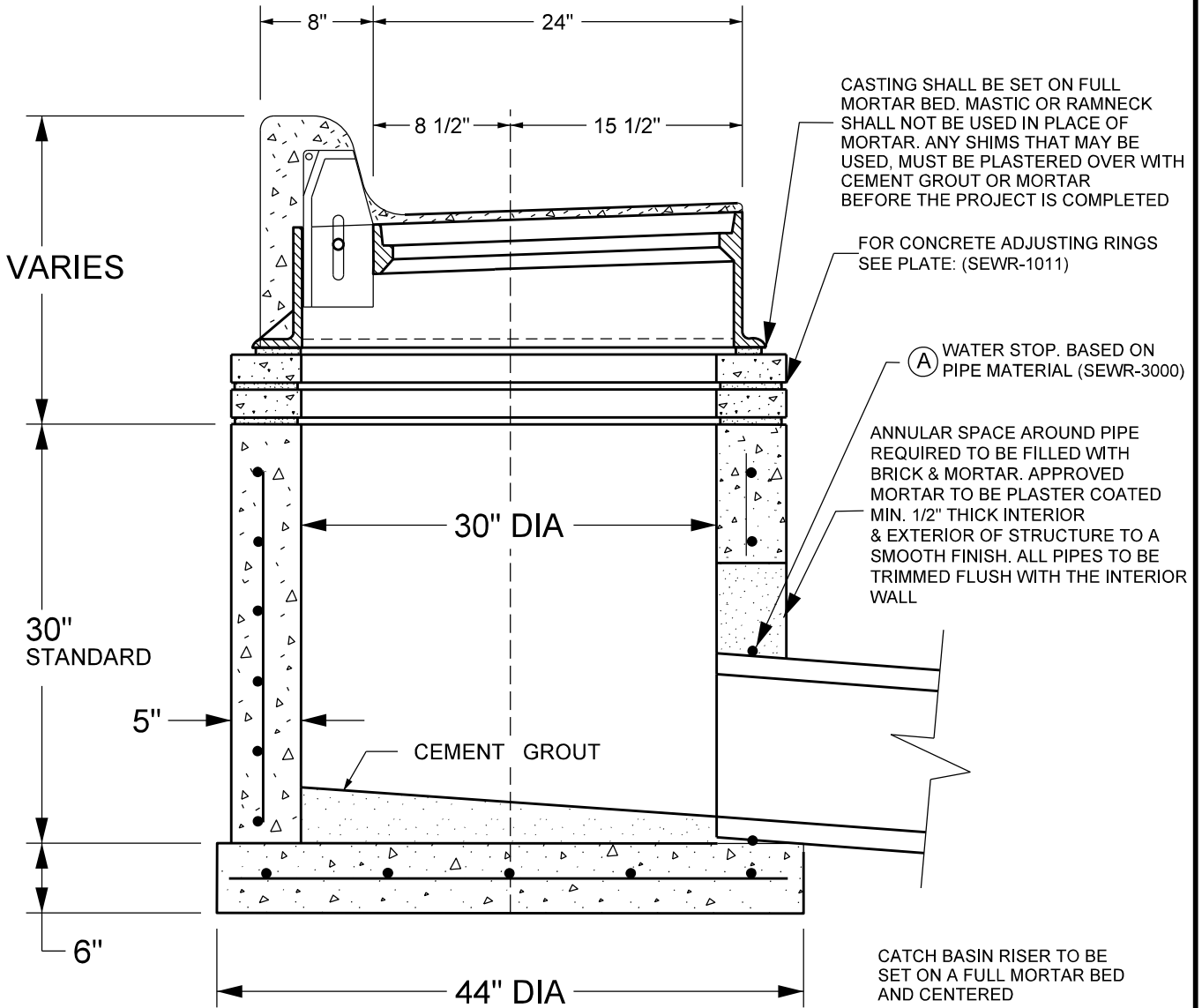

PUBLISHED SEWR PLATE REFERENCES:

- SEWR-1010
- SEWR-1011
- SEWR-2006
- SEWR-2007
- SEWR-2008
- SEWR-3000

MAXIMUM INSIDE BUILD HEIGHT OF 48"
 BUILD HEIGHT GREATER THAN 48"
 48" DIA STRUCTURE IS REQUIRED
 (UNLESS APPROVED BY ENGINEER)

Ⓐ MANUFACTURED PIPE CONNECTION POINT MUST BE AN APPROPRIATE SIZE FOR PIPE BEING USED.

MNDOT SPEC. REF. 2506
 DESIGN N MNDOT 4003B
 NOT TO SCALE



DRW: MJS

DATE: 02/24

APP: KMM

DATE: 04/24

STANDARD CATCH BASIN CONSTRUCTION

STANDARD
 PLATE
 NO.
 SEWR-1017-R1